

(1)

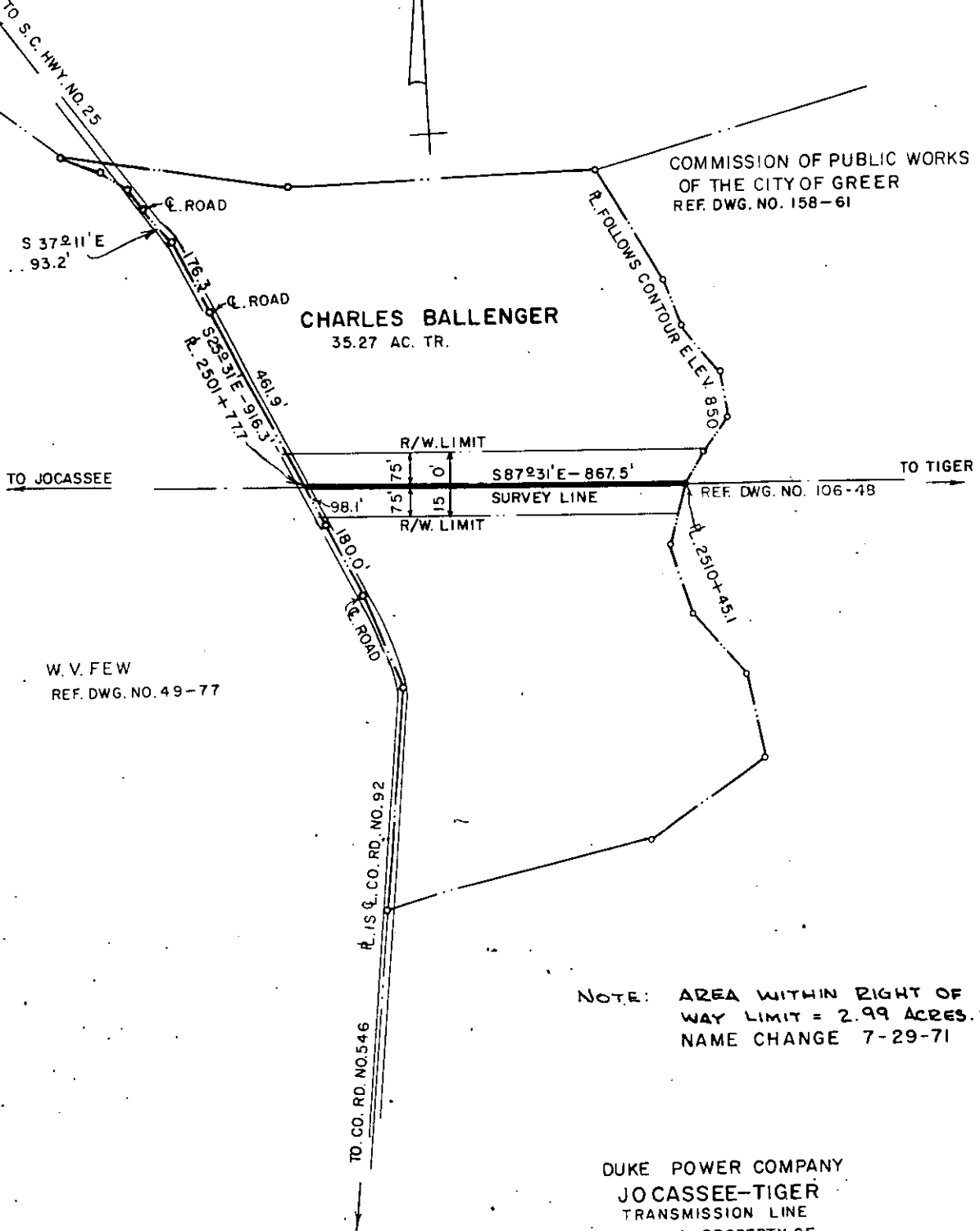

NOTE: AREA WITHIN RIGHT OF WAY LIMIT = 2.99 ACRES. NAME CHANGE 7-29-71

DUKE POWER COMPANY
JOCASSEE-TIGER
TRANSMISSION LINE
CROSSING PROPERTY OF
CHARLES BALLENGER
NEAR TRAVELERS REST, S.C.
ONEAL TOWNSHIP
GREENVILLE COUNTY

SCALE 1" = 300'
BOOK NO. 1196

FEBRUARY 13, 1970
FILE NO. 49-81

I.O. NO. 7123-187 Agreement
Plat and Right Of Way
Recorded October 13, 1971 at 2:31 P. M., #10808